

SBL36-25: dc brushless motor

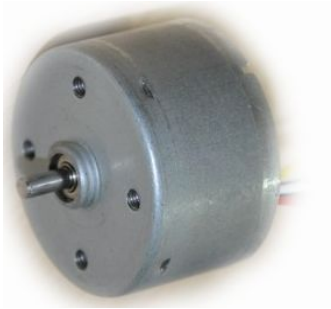

Description

- 1.Size: 36*25 mm
- 2.Voltage: 12V/24V
- 3.No load speed: 5000rpm
- 4.Rated torque: 90g.cm
- 5.Ball bearing
- 6.Built-in drive (5 wires)
- 7.PWM:Pulse-Width Modulation
- 8.CW/CCW
- 9.Overload protection
- 10.Life time:>10000 hours

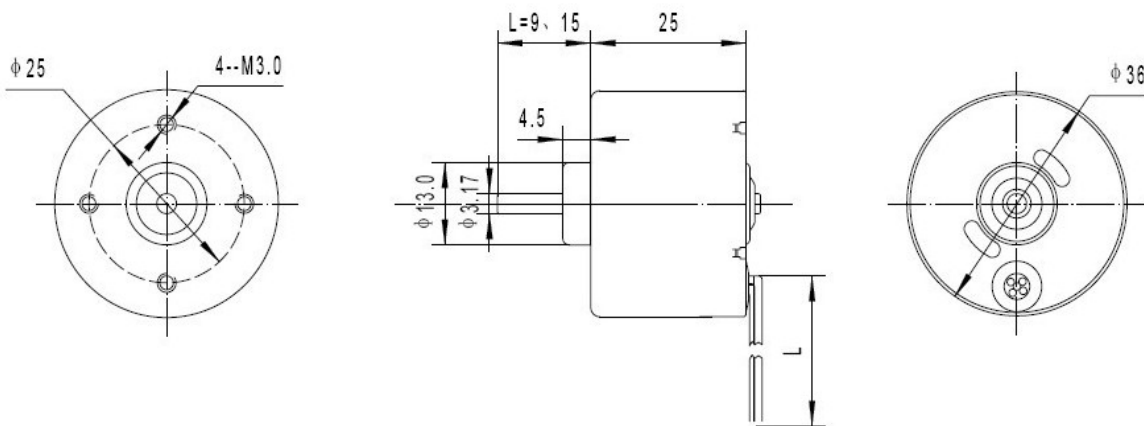

Voltage V	No load		At load				Stall	
	Speed/rpm	Current/A	Speed/rpm	Current/A	Torque/g.cm	Power/W	Current/A	Torque/g.cm
12	5000	0.13	4000	0.5	90	3	1.5	350
24	6000	0.08	4800	0.25	90	3	0.8	350

TEL:+86-755-89480927
 FAX:+86-755-88366423
 Web: www.sonth123.com
 Msn: sonth123@hotmail.com